

M81935/6 SELF-LUBRICATED ROD END BEARINGS

AS81935/6 • AS81935 (formerly MIL-B-81935)

- Male type, rod end
- High temperature — low wear
-65°F to +325°F (-53.9°C to +162.8°C)
- Material: Bearing inner ring: CRES PH13-8Mo, HRC 43-47
Bearing outer ring: CRES 17-4PH
Rod end housing: CRES PH13-8Mo, HRC 40-44, passivated
- Liner: Fibriloid® or “E” Uniflon® qualified to AS81820
- Rolled threads conform to UNJF-3A per AS8879
For rod ends with left hand thread add “L” or “1” depending on part number ordered. Example: see below
- For rod ends with slotted shank or “keyway” add “K” or “1”
Example: see below

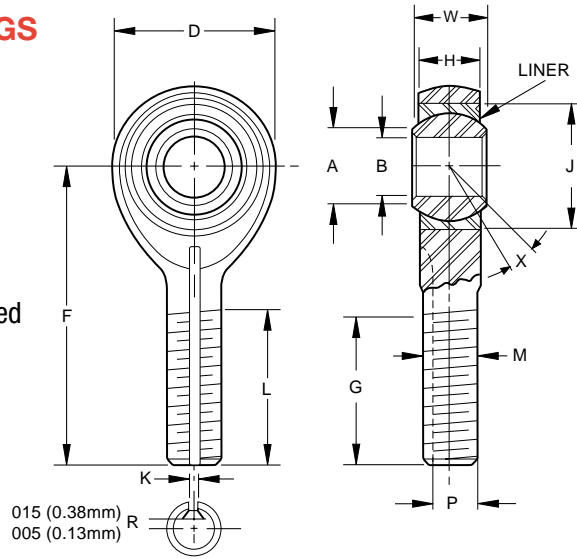

SPECIFICATIONS AND ORDERING INFORMATION

DIMENSIONS — TOLERANCES

PART NUMBERS			B		D		L		F		W		H		A		J		G		K ⁽¹⁾		p ⁽¹⁾		M	X°
MPHE Dash No.	01-820 Dash No.	M81935/6 Dash No.	+0.000, -0.005 +0.00, -0.13	±0.10 +0.25	±0.10 ±.79	±0.10 +0.25	+0.000, -0.002 +0.00, -0.05	±0.005 +0.13	Min.	Max.	Min.	Max.	+0.000, -0.020 +0.00, -0.51	+0.005, -0.000 +0.13, -0.00	+0.000, -0.005 +0.00, -0.13	UNJF-3A PER AS8879	Min.									
			in.	mm	in.	mm	in.	mm	in.	mm	in.	mm	in.	mm	in.	mm	in.	mm	in.	mm	in.	mm	in.	mm		
03	-03	-03	.1900	4.826	.806	20.47	.968	24.59	1.562	39.67	.437	11.10	.337	8.56	.30	7.6	.6250	15.875	.980	24.89	.062	1.57	.268	6.81	5/16-24	15
04	-04	-04	.2500	6.350	.806	20.47	.968	24.59	1.562	39.67	.437	11.10	.337	8.56	.30	7.6	.6250	15.875	.980	24.89	.062	1.57	.268	6.81	5/16-24	15
05	-05	-05	.3125	7.938	.900	22.86	1.187	30.15	1.875	47.62	.437	11.10	.327	8.31	.36	9.1	.6875	17.462	1.270	32.26	.062	1.57	.268	6.81	5/16-24	14
06	-06	-06	.3750	9.525	1.025	26.04	1.187	30.15	1.938	49.23	.500	12.70	.416	10.57	.47	11.9	.8125	20.638	1.235	31.37	.093	2.36	.319	8.10	3/8-24	8
07	-07	-07	.4375	11.112	1.150	29.21	1.281	32.54	2.125	53.98	.562	14.27	.452	11.48	.54	13.7	.9062	23.017	1.402	35.61	.093	2.36	.383	9.73	7/16-20	10
08	-08	-08	.5000	12.700	1.337	33.96	1.468	37.29	2.438	61.93	.625	15.88	.515	13.08	.61	15.5	1.0000	25.400	1.589	40.36	.093	2.36	.445	11.30	1/2-20	9
10	-10	-10	.6250	15.875	1.525	38.74	1.562	39.67	2.625	66.68	.750	19.05	.577	14.66	.75	19.1	1.1875	30.162	1.683	42.75	.125	3.18	.541	13.74	5/8-18	12
12	-12	-12	.7500	19.050	1.775	45.08	1.687	42.85	2.875	73.02	.875	22.22	.640	16.26	.85	21.6	1.3750	34.925	1.808	45.92	.125	3.18	.663	16.84	3/4-16	13
14	-14	-14	.8750	22.225	2.025	51.44	2.000	50.80	3.375	85.72	.875	22.22	.765	19.43	1.061	26.95	1.6250	41.275	2.121	53.87	.156	3.96	.777	19.74	7/8-14	6
16	-16	-16	1.0000	25.400	2.775	70.48	2.343	59.51	4.125	104.78	1.375	34.92	1.015	25.78	1.27	32.3	2.1250	53.975	2.464	62.59	.187	4.75	1.136	28.85	1 1/4-12	12

⁽¹⁾Keyway when specified, is compatible with locking devices, AS81935/3 for sizes 3 thru 8, and NAS559 for sizes 10 thru 16.
Keyway tolerances not specified shall be in accordance with AS81935/3 or NAS513 as applicable.

LOAD RATINGS

MPHE Dash No.	01-820 Dash No.	Ultimate Static Load		Fatigue Load		Axial Proof Load		Weight		No Load Rational Breakaway Torque			
		lb.	N	lb.	N	lb.	N	lbs.	kg	Min.	Max.	Min.	Max.
03	-03	2360	10400	1470 ⁽¹⁾	6550 ⁽²⁾	1000	4400	0.072	0.033	.5	.06	6	.68
04	-04	4860	21600	2380	10600	1000	4400	0.072	0.033	.5	.06	6	.68
05	-05	7180	32000	2770 ⁽³⁾	12200 ⁽³⁾	1100	4900	0.087	0.039	1	.11	15	1.70
06	-06	8550	38000	3570	16000	1660	7350	0.136	0.062	1	.11	15	1.70
07	-07	12000	53000	4800	21200	1850	8300	0.183	0.083	1	.11	15	1.70
08	-08	19500	86500	7680 ⁽³⁾	34000 ⁽³⁾	2040	9000	0.278	0.126	1	.11	15	1.70
10	-10	21900	98000	9180	40500	2430	10800	0.424	0.192	1	.11	15	1.70
12	-12	29300	129000	11600	52000	2810	12500	0.639	0.290	1	.11	15	1.70
14	-14	34500	153000	13100	58500	3320	14600	0.963	0.437	1	.11	24	2.71
16	-16	80300	355000	30400	134000	4340	19300	2.546	1.150	1	.11	24	2.71

⁽¹⁾Based on bolt bending fatigue strength 180000 psi

⁽²⁾Based on bolt bending fatigue strength 127kg/mm².

⁽³⁾Shank limitation

Notes: For liner specifications or the following options:

- Stainless steel rod end body
- High temperature or high speed liners

Please see engineering section or contact RBC Aerospace Bearings.

Bearing configuration	Part number designations for a 0.2500 in. bore rod end		
Base P/N (no options)	MPHE04	01-820-04	M81935/6-04
Keyway on threads	MPHEK04	01-820-041	M81935/6-04K
Left hand thread	MPHEL04	11-820-04	M81935/6-04L