

# Large Bearings

## Large Diameter Cylindrical and Ball Bearings

A full range of large diameter, high quality cylindrical roller and ball bearings in standard and custom designs to 1500 mm (60 in.) O.D.



- World-class lead times
- Flexible manufacturing
- Design and manufacture of special and obsolete bearings
- 50 years of experience supporting global customers
- Target markets: Gear Box, Paper, Steel, Mining and Aggregate



ISO 9001:2000

[www.rbcbearings.com](http://www.rbcbearings.com)  
800.390.3300

# Large Bearings

## Large Diameter Cylindrical and Ball Bearings

### HEAVY DUTY ROLLER BEARINGS

#### Full Complement Bearings

- **Double Row Semi-Locating**  
SL 1849 / 1850 Series  
NNCF 4900 / 5000 Series
- **Single Row Semi-Locating**  
SL 1829 / 1830 / 1822 / 1818 / 1923 Series  
NCF 29 / 30 / 22 / 18 / NJG 23 Series
- **Double Row Locating**  
SL 0148 / 0149 Series  
NNC 48V / 49V Series
- **Double Row Non-Locating**  
SL 0248 / 0249 Series  
NNCL 48 / 49 Series
- **Three & Four Row with Two Piece or Plain Outer Ring**  
SL 119 / 149 Series  
SL 129 / 159 Series

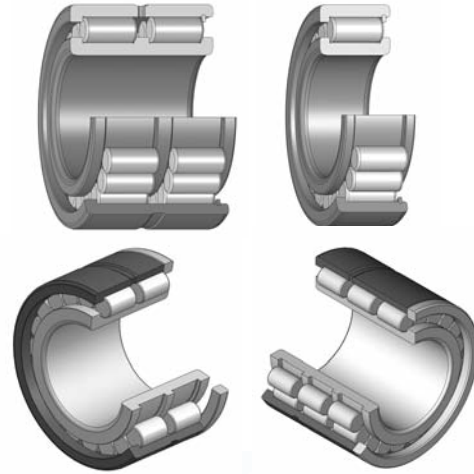

#### Brass Caged Roller Bearings

- **Single Row Roller Bearings with Brass Cage**  
N / NF / NP / NU / NJ / NUP / NC Series
- **Double Row Roller Bearings with Brass Cage**  
NNU 4900 Series  
NNU 4100 Series
- **Four Row Roller Bearings with Brass Cage**

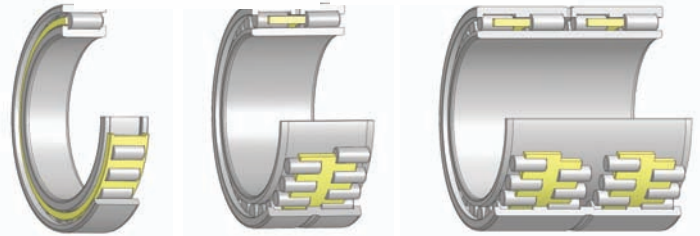

### BALL AND ROLLER BEARINGS – Inch Sizes

- XLJ / LJ / MJ / N-Specials / QJL / QJM / XLJT / LJT / MJT / LRJ / LRJA / LLRJ / LLRJTA / LLRJB / LLRJN / MRJ / MRJA / MMRJ / MMRJA + HJM / MMRJB / MMRJN / L Specials / XLRJ / XLRJA / LSN / MSN / RLSN / RMSN / RMSNE / NLJ / NMJ

### BALL BEARINGS

- **Deep Groove Radial Ball Bearings with Brass Cage**  
16000 / 6000 / 6200 / 6400 / 61800 / 61900 Series
- **Duplex Ball Bearings with Brass Cage**  
QJ 1000 / QJ 1200 / QJ 1900 / QJ 200 / QJ 300 / QJ 400 Series
- **Angular Contact Ball Bearings with Brass Cage**  
71900 / 7000 / 7200 / 7300 / 7400 Series

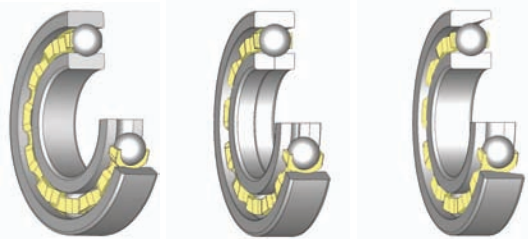

### CYLINDRICAL ROLLER THRUST BEARINGS

- 811 / 812 / 893 / 874 / 894 / T7 Series
- All with Brass Cage

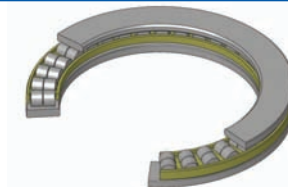

ISO 9001:2000

[www.rbcbearings.com](http://www.rbcbearings.com)  
800.390.3300