

## EN2335

### European Standards

- Swaged series, Corrosion resistant steel
- All dimensions are metric
- Material  
Outer ring: CRES 17-4PH, EN3490 or EN3161  
Inner ring: CRES 440C, EN2030
- Chamfered or grooved type
- Lubrication holes and grooves on the race
- Lubrication holes and grooves on the ball

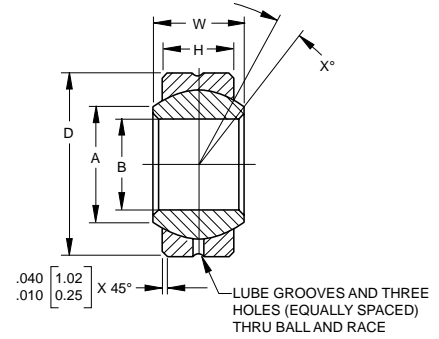

SPHERICAL BEARINGS

## SPECIFICATIONS AND ORDERING INFORMATION

Dash No	Ball					Outer race		Chamfer C	V-groove			Groove Pitch Dia. E	Loads		Movement				
	Ø B Bore	Ø A	W Width	Ø K	Ø D O. diam.	H Width	Ø P		N	R	Radial Cs		Axial Ca	Axial play		Radial play		Angle α°	Weight (g)
	Tol. (µm)	mini	h11	approx.	Tol. (µm)	±0.1 -0.25	+0.1 -0.0		+0.0 -0.2	+0.1 -0.0	(kN)		N (µm)	P (µm)	N (µm)	P (µm)	mini.		
04	4	6	5	8	12	3	0.3					7.2	0.45					16	3
05	5	6	6	10	14	4	to					12.6	0.8					13	5
06	6	8	6	10	14	4	0.8					16	1	35	5	20	10	13	5
08	8	10	8	13	16	5						21	1.8	to	to			15	8
10	10	13	9	16	19	6						31	2.5	75	35			12	12
12	12	15	10	18	22	7	0.5				20.2	40.5	3.5					11	17
15	15	18	12	22	26	9	to				24.2	70	5.3					8	32
17	17	20	14	25	30	10	1.2		0.7	0.2	28.2	91.4	6.7	40 to 80	5 to 40	25	12	10	49
20	20	24	16	29	35	12	0.6				33.2	130	9.8					9	65
25	25	29	20	36	42	16	to				39.4	216.7	18	50 to 100	5 to 50	30	15	7	115
30	30	34	22	41	47	18	1.5			0.3	44.4	277.5	25					6	160

Bearing configuration	Part number designations and options
EN2335 AP 12 ERT	12mm bore with Nato grease G354/Mil-G-23827, reduced internal clearance, no lubrication holes and grooves, swaging grooves and passivated per ISO8075
Suffix A is for grease type	A = Nato G354/Mil-G-23827 or B = Nato G395/Mil-G-81322
Suffix P is for radial and axial play	P = Reduced internal clearance or N = Normal internal clearance
Bore size	12 = 12mm bore
Suffix E is for type of lubrication	E = No lubrication holes and grooves, F = Lubrication holes and grooves in the ball G = Lubrication holes and grooves in the race
Suffix R is for type of mounting	R = Grooved type (sizes 12 and higher only) or S = Chamfered type
Suffix T is for passivation	T = Passivation per ISO8075 or Blank = No passivation