

DuraLube™ II

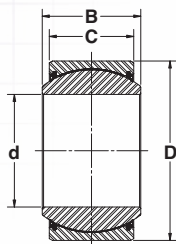

Maintenance Free Spherical Plain Bearings

Interchange Table - Inch Series



RBC Inch Series	Basic Dimensions				Recommended Load Limits ^①		
	d	D	B	C	Static Radial (lbf)	Static Thrust (lbf)	Dynamic Radial (lbf)
B16DLPTS	1.0000	1.6250	0.875	0.750	45,266	8,441	22,633
B20DLPTS	1.2500	2.0000	1.093	0.937	70,640	13,180	35,320
B22DLPTS	1.3750	2.1875	1.187	1.031	83,876	16,654	41,938
B24DLPTS	1.5000	2.4375	1.312	1.125	101,824	19,003	50,912
B28DLPTS	1.7500	2.8125	1.531	1.312	138,587	25,803	69,293
B32DLPTS	2.0000	3.1875	1.750	1.500	181,125	33,738	90,563
B36DLPTS	2.2500	3.5625	1.969	1.687	229,213	42,627	114,606
B40DLPTS	2.5000	3.9375	2.187	1.875	282,713	52,842	141,356
B44DLPTS	2.7500	4.3750	2.406	2.062	342,086	63,836	171,043
B48DLPTS	3.0000	4.7500	2.625	2.250	407,484	75,931	203,742
B52DLPTS	3.2500	5.1250	2.844	2.437	478,505	88,876	239,252
B56DLPTS	3.5000	5.5000	3.062	2.625	555,660	102,912	277,830
B60DLPTS	3.7500	5.8750	3.281	2.812	636,581	118,553	318,290
B64DLPTS	4.0000	6.2500	3.500	3.000	724,500	134,953	362,250
B729DLPTS	4.5000	7.0000	3.937	3.375	917,831	279,541	458,916
B809DLPTS	5.0000	7.7500	4.375	3.750	1,132,425	345,183	566,213
B969DLPTS	6.0000	8.7500	4.750	4.125	1,413,027	413,308	706,514
B1049DLPTS	6.5000	9.7500	4.875	4.062	1,497,050	387,039	748,525
B1129DLPTS	7.0000	10.5000	5.250	4.375	1,736,438	449,008	868,219
B1209DLPTS	7.5000	11.2500	5.625	4.687	1,993,147	515,309	996,573
B1289DLPTS	8.0000	12.0000	6.000	5.000	2,268,000	586,460	1,134,000
B1369DLPTS	8.5000	12.7500	6.375	5.312	2,560,118	661,906	1,280,059
B1449DLPTS	9.0000	13.5000	6.750	5.625	2,870,438	742,238	1,435,219
B1529DLPTS	9.5000	14.2500	7.125	5.937	3,197,965	826,830	1,598,983
B1609DLPTS	10.0000	15.0000	7.500	6.250	3,543,750	916,344	1,771,875
B1689DLPTS	10.5000	15.7500	7.875	6.562	3,906,687	1,010,081	1,953,343
B1769DLPTS	11.0000	16.5000	8.250	6.875	4,287,938	1,108,776	2,143,969
B1849DLPTS	11.5000	17.2500	8.625	7.187	4,686,283	1,211,659	2,343,142
B1929DLPTS	12.0000	18.0000	9.000	7.500	5,103,000	1,319,535	2,551,500

DLP is RBC's DuraLube™ II Plus Liner System. RBC has other advanced liner systems designed for specific operating conditions. For specific technical details or custom designed solutions, please consult with your RBC Sales or Application Engineering Representative, or visit www.rbcbearings.com/DuraLube.

① Ultimate static and impact loads should not exceed 150% of catalog ratings.

RBC: Your Maintenance Free Solution Provider

www.rbcbearings.com

800.390.3300

RBC has been producing bearings in the USA since 1919. In addition to unique custom bearings, RBC offers a full line of standard industrial and aerospace bearings.

Interchange Table - Metric Series

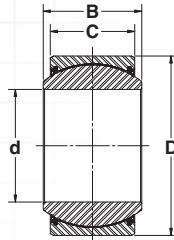

RBC Metric Series	Basic Dimensions				Recommended Load Limits		
	d	D	B	C	Static Radial (kN)	Static Thrust (kN)	Dynamic Radial (kN)
GE20DLPTS	20	35	16	12	155	24.3	87
GE25DLPTS	25	42	20	16	248	43.2	139
GE30DLPTS	30	47	22	18	317	54.7	178
GE35DLPTS	35	55	25	20	413	67.5	231
GE40DLPTS	40	62	28	22	520	81.7	292
GE45DLPTS	45	68	32	25	645	106	362
GE50DLPTS	50	75	35	28	807	132	452
GE60DLPTS	60	90	44	36	1254	219	703
GE70DLPTS	70	105	49	40	1617	270	906
GE80DLPTS	80	120	55	45	2070	342	1160
GE909LDLPTS	90	130	60	50	2516	422	1410
GE1009LDLPTS	100	150	70	55	3169	511	1776
GE1109LDLPTS	110	160	70	55	3382	511	1895
GE1209LDLPTS	120	180	85	70	4816	827	2699
GE1409LDLPTS	140	210	90	70	5629	827	3155
GE1609LDLPTS	160	230	105	80	7086	1081	3972
GE1809LDLPTS	180	260	105	80	8050	1081	4512
GE2009LDLPTS	200	290	130	100	11395	1689	6387
GE2209LDLPTS	220	320	135	100	12298	1689	6893
GE2409LDLPTS	240	340	140	100	13158	1689	7375
GE2609LDLPTS	260	370	150	110	15751	2043	8828
GE2809LDLPTS	280	400	155	120	18576	2432	10411
GE3009LDLPTS	300	430	165	120	19350	2432	10845
GE3209LDLPTS	320	440	160	135	22059	3077	12363
GE3409LDLPTS	340	460	160	135			

DLP is RBC's DuraLube™ II Plus Liner System. RBC has other advanced liner systems designed for specific operating conditions. For specific technical details or custom designed solutions, please consult with your RBC Sales or Application Engineering Representative, or visit www.rbcbearings.com/DuraLube.



Smoother. Faster. Longer. Because That's How We Roll.

www.rbcbearings.com 800.356.6584

This document contains a general overview of the products and features described herein. It is solely for informational purposes, does not represent a warranty of the information contained herein, and is not to be construed as an offer to sell or a solicitation to buy. Contact RBC Bearings® for detailed information suitable to your specific applications. RBC Bearings® reserves the right to modify its products and related product information at any time without prior notice. Some of the products listed herein may be covered by one or more issued and pending U.S. or foreign patents. Contact RBC Bearings® for product specific information - or see rbcbearings.com/patents/

